



THS-08240E

# 82' x 40' Ship Assist Tug All Electric

Crowley has developed a cutting-edge, fully electric ship assist tugboat, a first of its class. It operates emissions-free thanks to a robust battery system and energy-saving tech. In addition to two emergency generators for extended transit, it features 360-degree visibility from the pilot's station, ensuring clear views without exhaust stacks. Designed for future autonomous operations, it completes two ship assist jobs per harbor charge. The modular battery system allows for easy upgrades, maintaining ABS Class and U.S. Coast Guard Sub-Chapter M compliance.

## Overall Dimensions

Molded Length .....	82'
Length at Waterline .....	78' 4"
Depth.....	17' 9"
Design Draft .....	16' 5"
Beam .....	40'
Bollard Pull.....	70 short-tons (estimated)
Speed .....	12 knots
Gross Tonnage .....	(US Regulatory)<200 GRT
Bow & Stern Winch.....	
	Markey Model DEPC-48-50HP
	Electric Reel/Recover Winch
Generators for Long Transit.....	2 x 300kW
Fuel .....	9800 gal@95%

## Specification Highlights

Main Propulsion Battery .....	6.2 MWh
Thrusters .....	2x Azimuthing Thruster
Electric Motors .....	2 x 2100kW Motors
Switchboards.....	DC Grid and AC
	Switchboards
Intelligent Maneuvering .....	Pilot Control
Fresh Water .....	750 gal
	Battery Room Fixed Suppression Water Mist
Berths .....	4

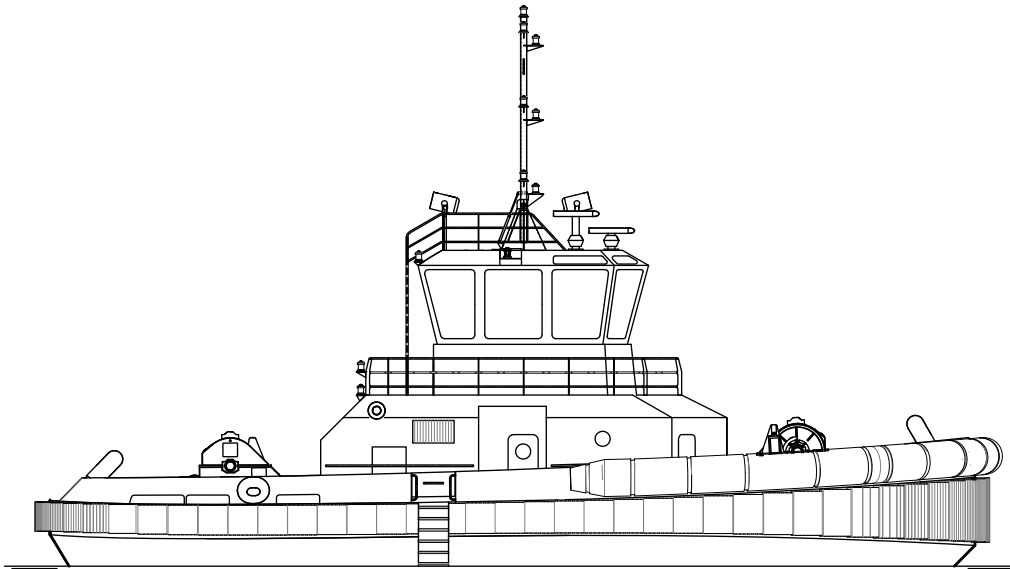

OUTBOARD PROFILE

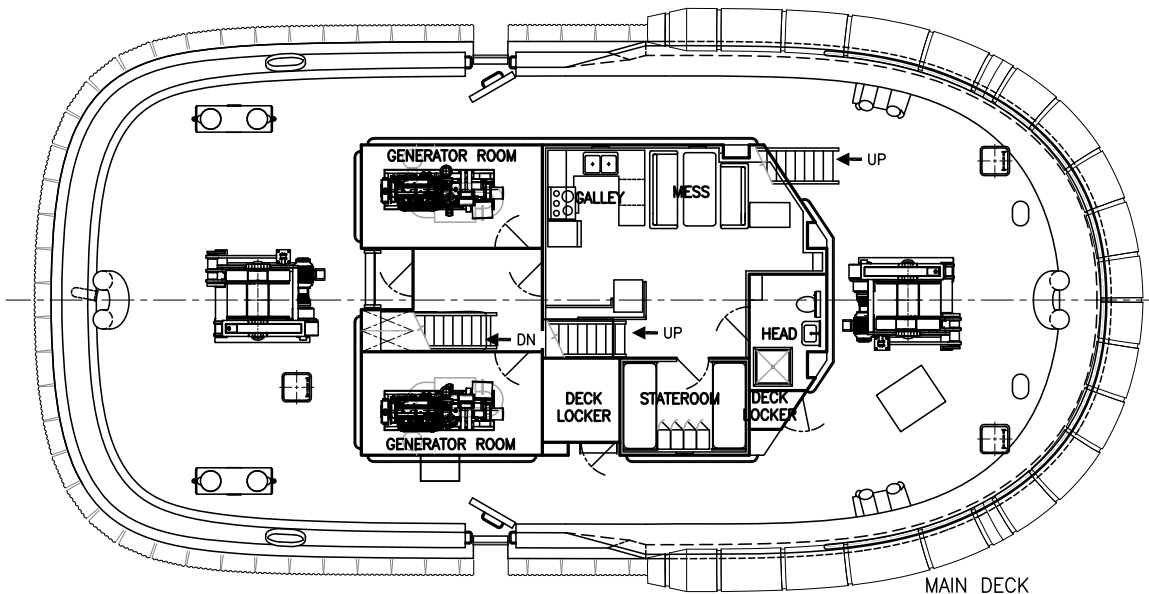

MAIN DECK

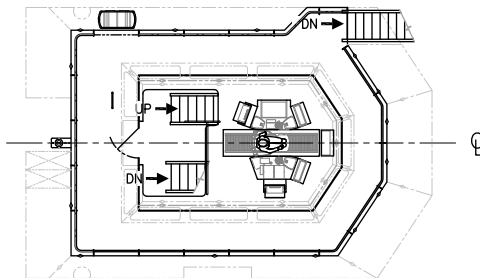

BRIDGE DECK