



THS-08636

86' x 36' Ship Assist Tug

The 86' Z-Drive Tug is a maneuverable and powerful tug for ship assist and escort work. Equipped with twin Kongsberg Z-Drive propulsion units and Caterpillar engines, 5,100 horsepower is available. A deep skeg forward is provided for escort work, with an open skeg aft to allow better maneuverability. The skeg also provides for a more stable platform when underway, minimizing rolling due to the seaway. An escort hawser winch is installed forward and the aft deck is fitted with an H-bitt and hydraulic capstan, alternative deck arrangements can be made to accommodate the vessels operations. The large windows allow for full 360-degree visibility from the helm and the vessel has 4 staterooms to accommodate a crew of 6.

Overall Dimensions

Length	86'
Breadth	36'
Depth, molded	15'-10"
Construction	Steel
Loaded Draft, molded.....	17'-6"
Bollard Pull.....	66 ST
Fuel Oil.....	21,750 gal
Lube.....	500 gal

Specification Highlights

Main Engines	2 x Caterpillar 3512E-HD Tier 4
Auxiliary Engines.....	2 x John Deere 6068TFM 99 kW ea
Propulsion	2 x Kongsberg Azimuth Thrusters
Horsepower	5,100 HP
Hawser Winch	Markey DEPC-48, 50 HP Full render / recover winch
Deck Machinery	Markey CEW-60 Capstan

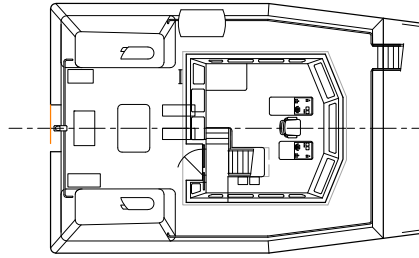

BRIDGE DECK

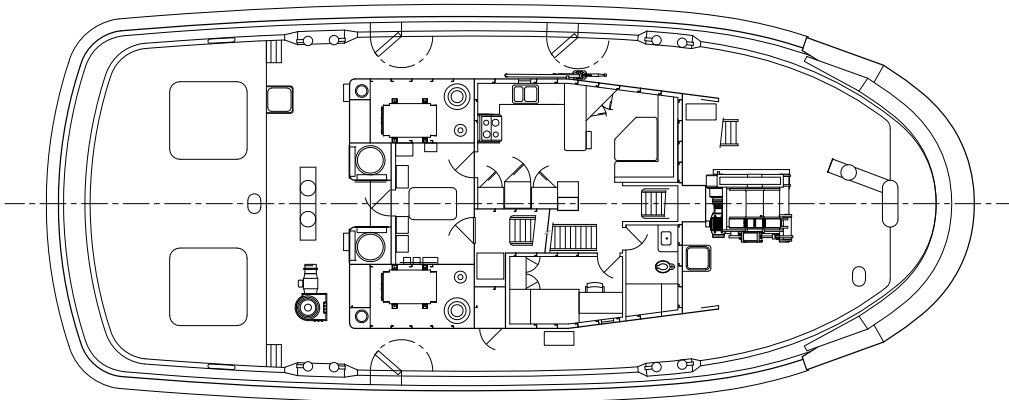

MAIN DECK

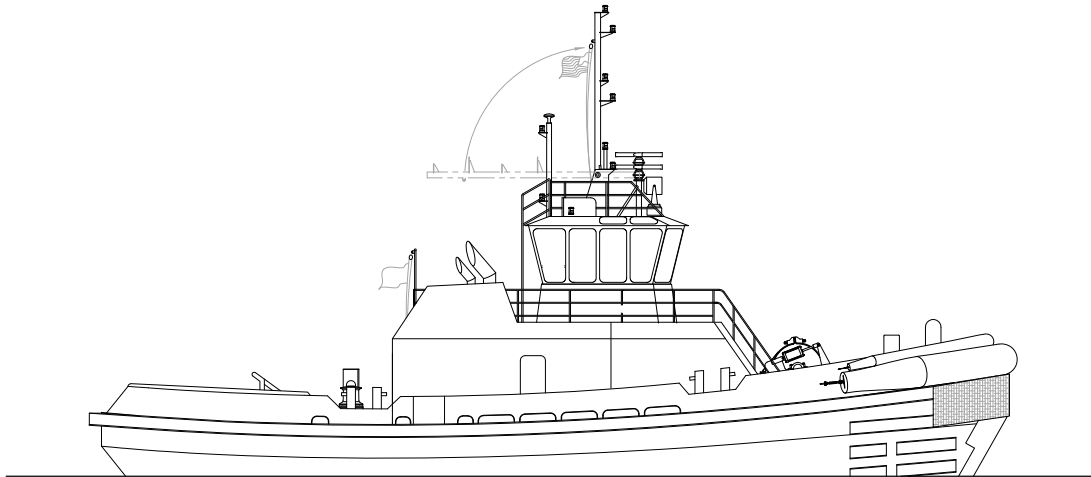

OUTBOARD PROFILE