



TWB-26966H

# 269' x 66' AHTS Workboat

The 269' AHTS Workboat is a next generation anchor handler tug supply vessel, designed to support drill and exploration operations in extreme Arctic and Antarctic waters. This vessel meets Polar Class 3 requirements for unlimited operations in the Arctic environment. Propulsion can range from conventional mechanical drive through diesels to diesel-electric propulsion with azimuthing stern drives or Voith VSP units with integral roll dampening capability. A gantry crane or a pair of rail cranes or fixed cranes may be installed.

The vessel is designed with full FFV-1 firefighting capability, is DP2 equipped for station keeping, has provision storage for up to 40 days duration, and is outfitted as an Oil Recovery Vessel Class 1. Anchor handling capability is optimized while maintaining the capability to carry up to 661 ST of deck cargo. The bridge is spacious with separate consoles for ship handling and winch controls aft, a DP console and sufficient room for installation of charterer's equipment module. A lounge, offices for the ship's crew and the charterer, outside staterooms with individual heads, and a hospital capable of handling up to two individuals at a time is provided. Crew accommodations can be adjusted to suit client requirements.

## Overall Dimensions

Overall Length.....	269'	Fresh Water .....	72,383 gal
Molded Breadth .....	66'	Capacity.....	3,197 ST DWT
Molded Depth .....	27'-3"	Berths .....	27+
Bollard Pull.....	Min 165 ST	Propulsion .....	Diesel-electric drive, 2 x ABB Azipod or Rolls Royce ARC1 azimuthing stern drives
Fuel Oil (98%).....	436,148 gal		

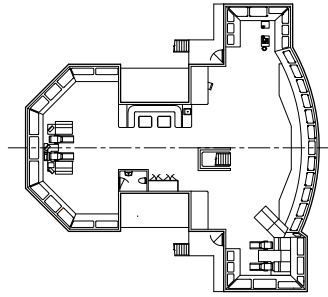

BRIDGE DECK

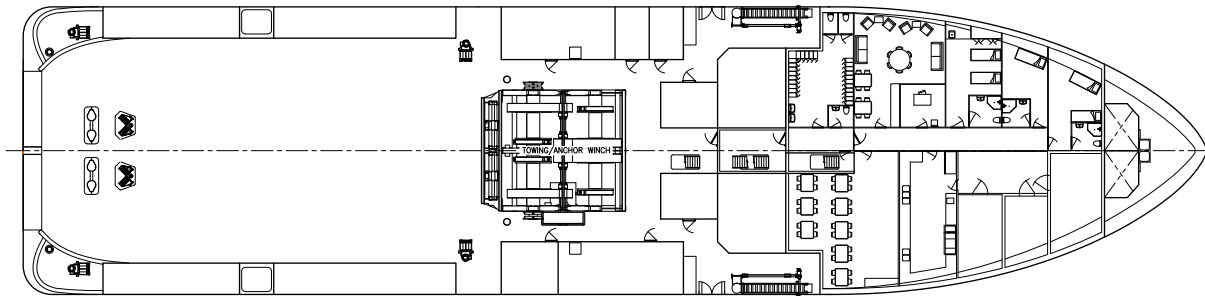

MAIN DECK

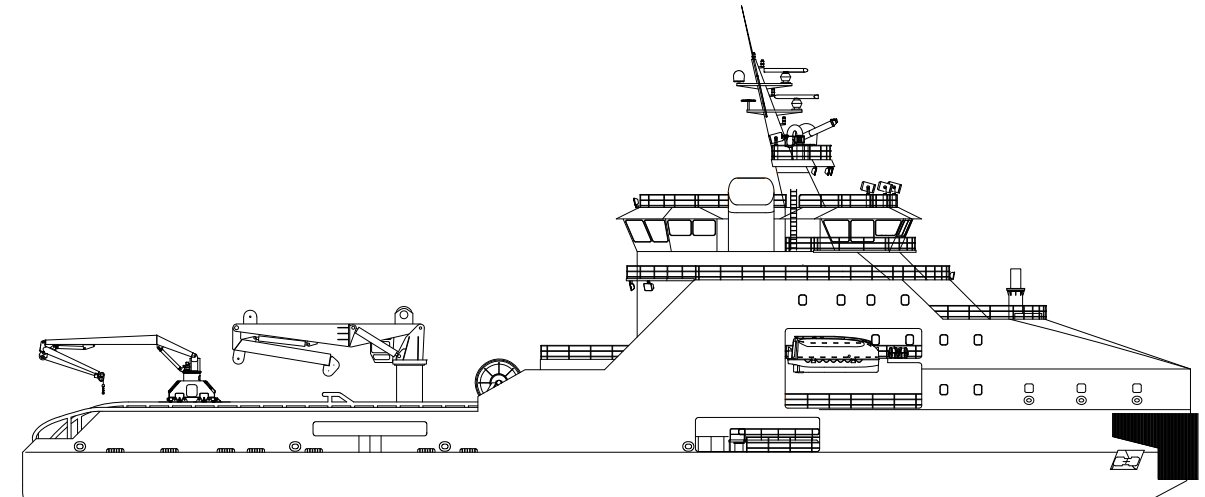

OUTBOARD PROFILE