



TWB-05522

# 55' x 22' Dredge Tender

The 55' x 22' Dredge Tender has more than 1,500 horsepower and engines that meet the EPA's Tier III emissions regulations. It is more reliable and easier to operate with the assistance of a bow thruster than older dredge tenders, resulting in more efficient dredging, lower environmental impacts, and reduced wear and tear on the vessel and crew.

## Overall Dimensions

Overall Length ..... 55'  
 Molded Breadth ..... 22'  
 Molded Depth ..... 7'-6"  
 Fuel Oil ..... 2,450 gal  
 Lube Oil ..... 100 gal  
 Fresh Water ..... 125 gal

Propulsion ..... 2 x Cummins QSK  
 19-M Diesels 760 HP  
 @ 2100 RPM each  
 Power ..... 2 x 250 kW Cummins Gensets  
 Bowthrusters ..... 2 x Wesmar 100 HP  
 Split Hull Dredge Capacity ..... 518 cubic  
 yards

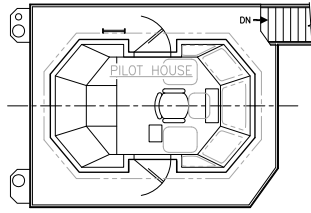

BRIDGE DECK

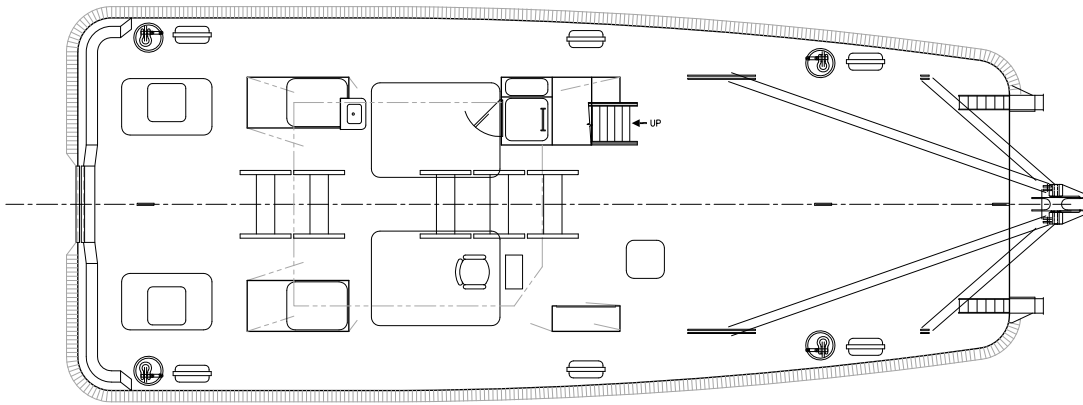

MAIN DECK

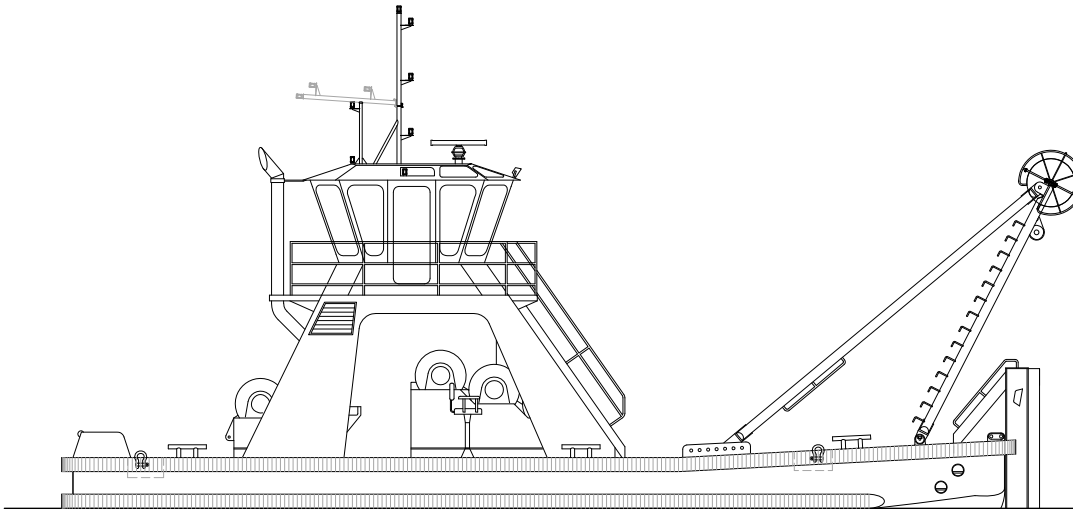

OUTBOARD PROFILE