



THS-07837

78' x 37' Ship Assist Tug

This design was developed to provide a maneuverable, powerful, yet smaller ship-assist tug to minimize some of the costs of building and operating a larger harbor tug. The design incorporates features that allow it to be built as either a conventionally powered tug or as an ASD.

This vessel was designed to ABS class ∇ A1, Towing Vessel, ABCU, +AMS, UWILD, with Fire Fighting capabilities. Other options include forward hawser winch and a hydraulic crane. Full 360-degree visibility from the helm is assured with windows all around, and controls are located on consoles port and starboard of the centerline helm position.

Overall Dimensions

| | | | |
|----------------------------|--------------------------------|-----------------------------|--------------|
| Overall Length..... | 78' | Propulsion System..... | 2 x Z-Drives |
| Molded Breadth..... | 37'-9" | Power Generators..... | 2 x 75 kW |
| Molded Draft..... | 16'-5" | Bollard Pull..... | 72 ST |
| Offship Fire Fighting..... | 2 x monitors w/ water spray | Fuel Oil Storage Tanks..... | 18,805 gal |
| Speed at Design Draft..... | 12 knots | Fuel Oil Day Tanks..... | 7,775 gal |
| Main Engine..... | 2 x 2,000 kW @ 1800 RPM | Lube Oil..... | 528 gal |
| | | Gray Water Holding..... | 1,585 gal |

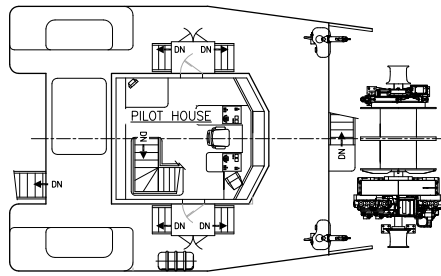

BRIDGE DECK

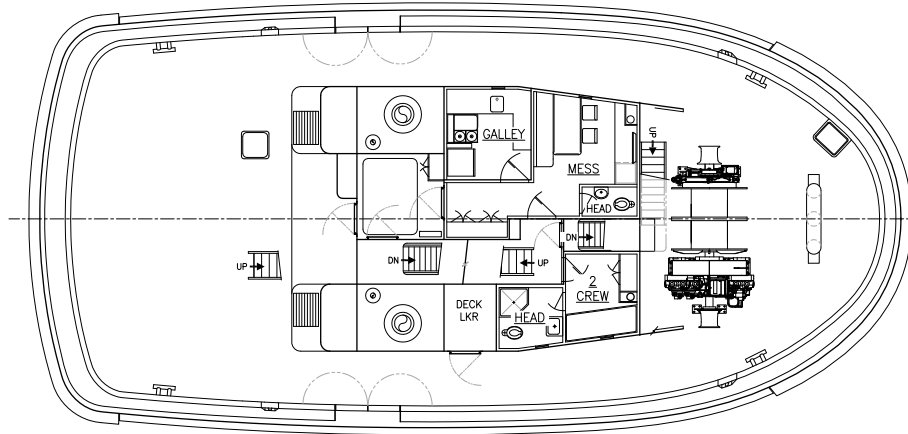

MAIN DECK

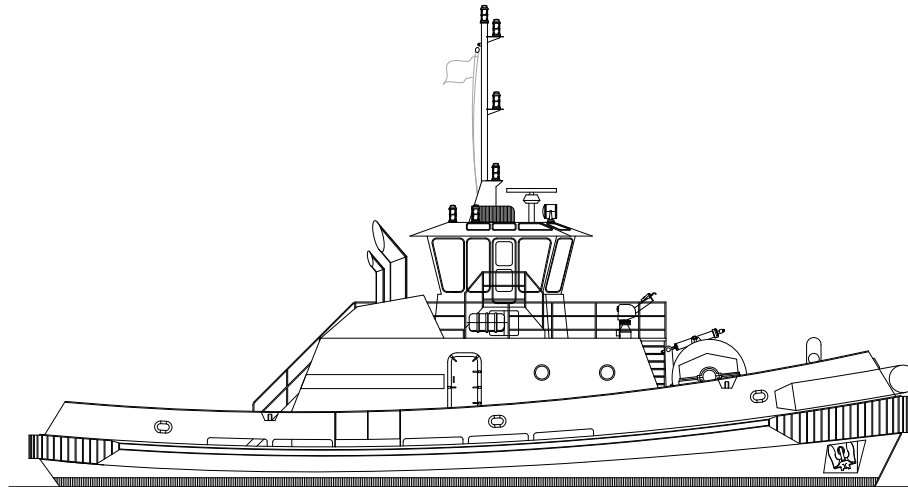

OUTBOARD PROFILE