

**TLH-12035**

# 120' x 35' Line Haul Tug

This 120' x 35' Line Haul Tug is based on the successful Titan class tugboats as part of Crowley's continued commitment to meeting the ocean towing needs of its project management customers. Powered by twin GE 8L250 EPA Tier II engines, each rated at 2679 HP/1999KW @ 900 RPM, the ABS Maltese Cross A1, Towing Service, Machinery-Classed vessel consumes significantly less fuel and enjoys much lower maintenance costs than other equivalently powered oceangoing tugboats. The tug is fitted with a pair of Schottel 1515 Z-drive units for superior maneuverability of tows in port and in close quarters. Measuring 494 International tons and 99 US Regulatory tons, the tug is qualified to sail in all U.S and worldwide waters with the smallest possible crew.

## Overall Dimensions

Overall Length..... 120'  
 Molded Breadth ..... 35'  
 Molded Depth ..... 21'  
 Bollard Pull..... 80 ST  
 Crew Complement ..... 4-11  
 Certifications ..... ABS + A1,  
 AMS Machinery Class,  
 Towing Service All Oceans  
 Navigation Equipment ..... Dual Radars,  
 Satellite Communication, VHF Radios  
 Fuel Capacity..... 154,914 gal  
 Fresh Water ..... 14,058 gal

Double-Drum Winch ..... JonRie Series 500  
 Headline Winch ..... JonRie Series 200  
 Tonnage ..... 99 US Regulatory  
 494 International  
 Horsepower ..... Total 5358 @ 900 RPM  
 Main Propulsion..... 2 x GE 8L250  
 Z-Drive Thrusters ..... 2 x Schottel 1515FP,  
 2600 MM Diameter Stainless Propeller  
 Ship's Service Power..... 2 x John Deere  
 6081A/ Kohler Generators, 180 kW  
 Emergency Tow Line..... 600'-7" Dyneema  
 Towing Package

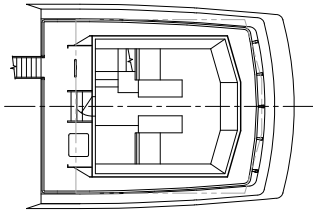

BRIDGE DECK

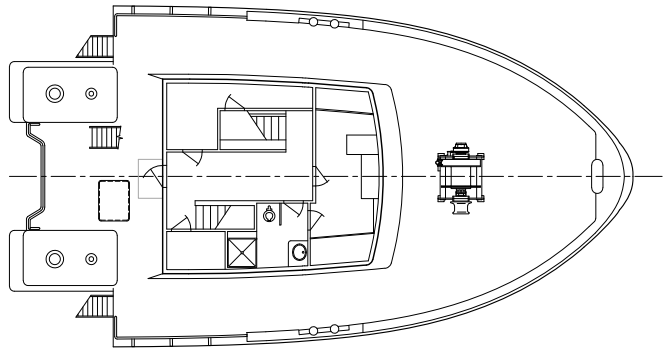

FOC'SLE DECK

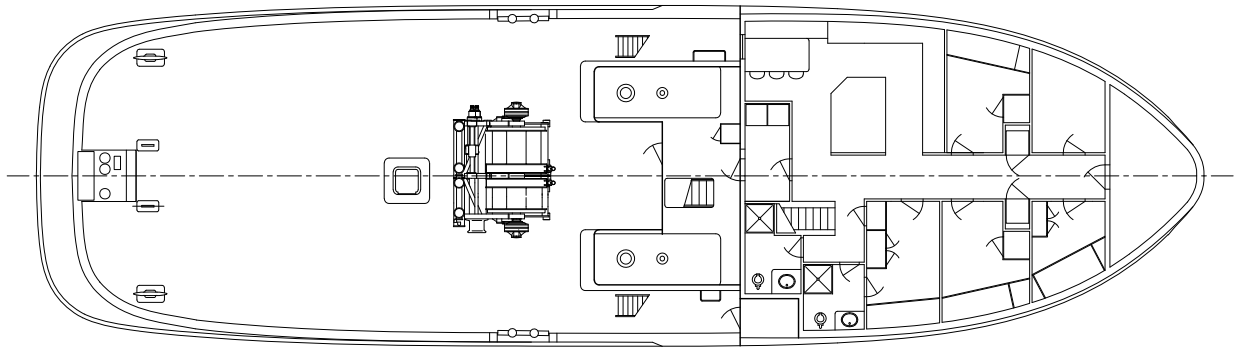

MAIN DECK

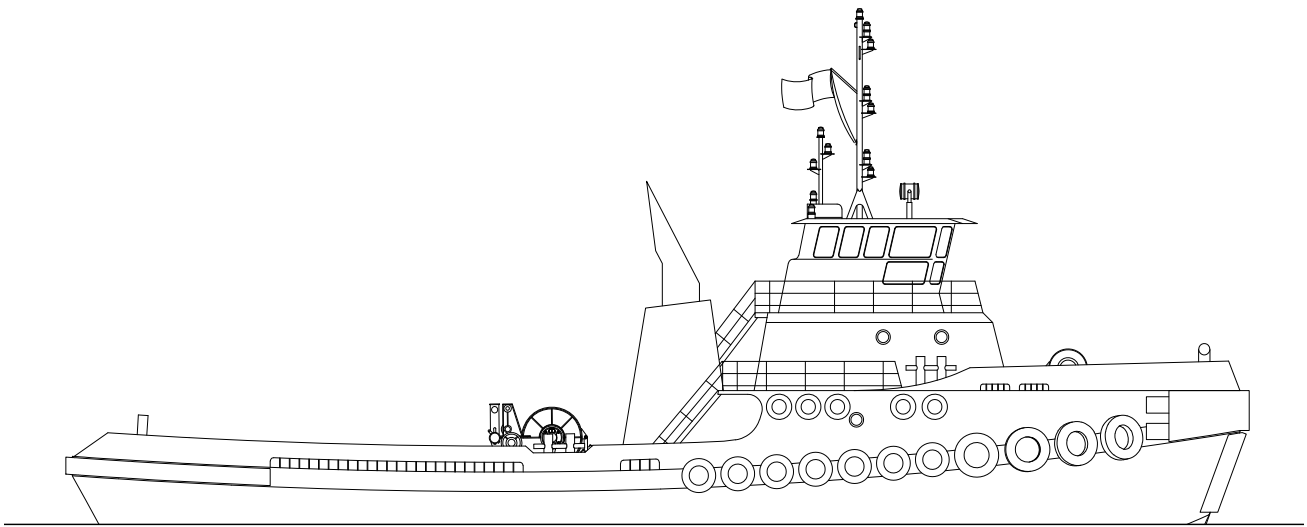

OUTBOARD PROFILE