



FVC-08526

85' Crabber

This vessel is a conventional single chine, steel hull vessel with house and engine room forward. Fuel is carried in wing tanks aft, outboard of the three holds. In a unique configuration, the aft two holds are set up as freezer holds, and the forward hold is set up for RSW. Engine room has three generators, two 100-kW sets for normal ship loads and a smaller 25-kW set for harbor loads.

The crew accommodations are located forward on the Main Deck, with a single 4-man stateroom and one 2-man stateroom. A separate change room is located aft as a buffer between the weather and the accommodations to help isolate the living quarters from noise and the weather. A large galley and mess area provide a comfortable gathering place for the crew for those brief moments of relaxation. The Skipper's Stateroom is located on the Fore Deck aft of the bridge area.

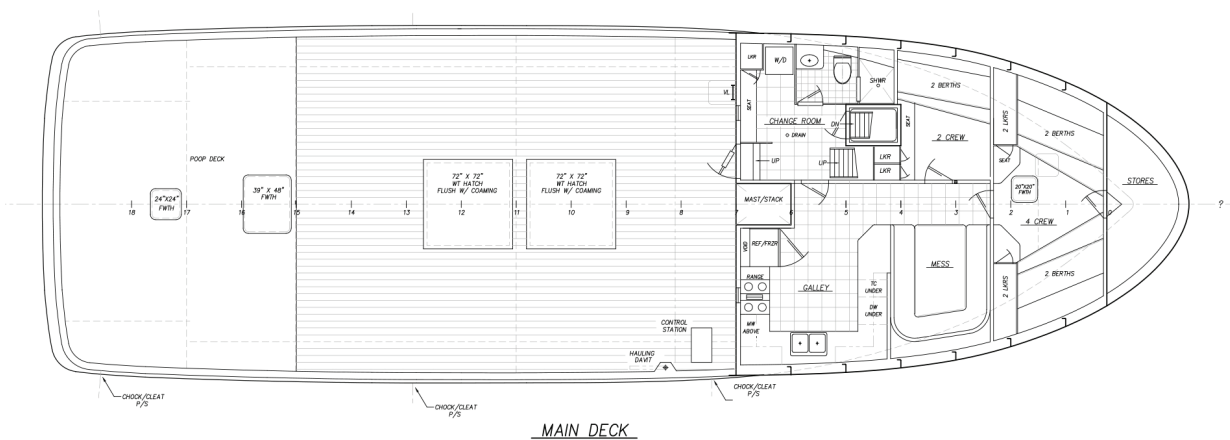
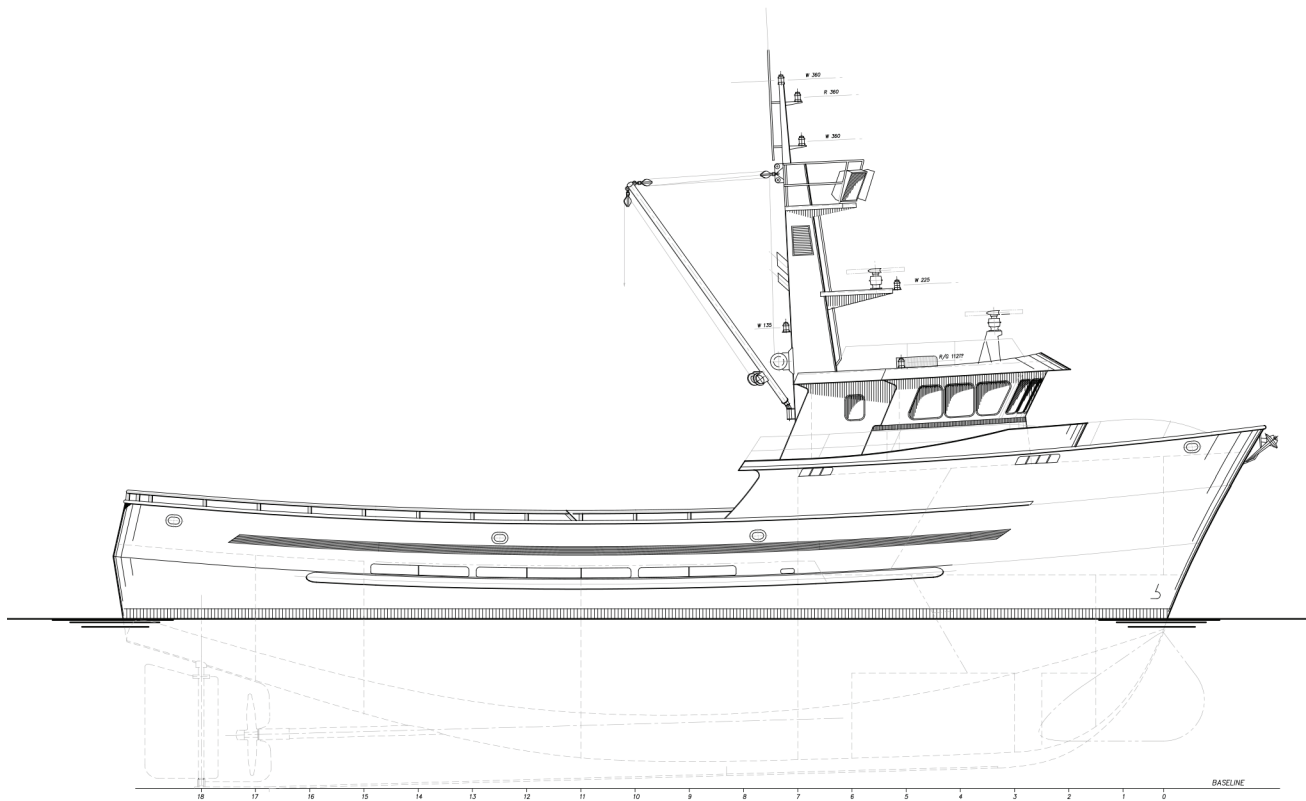

Vessel Specifications

Overall Dimensions

Length Overall	85'-0"	Fuel Capacity	18,250 gal
Breadth	26'-0"	Fresh Water Capacity	2,000 gal
Depth	13'-3"	RSW Capacity	2850 cu. ft.
Engine Horsepower	660 BHP	Cargo Hold Volume	3350 cu. ft.
Gross Tonnage	<200 ITC		

206.332.8090

crowley.com/vesseldesign
Seattle, WA • Jacksonville, FL

CROWLEY[®]
People Who Know[®]