

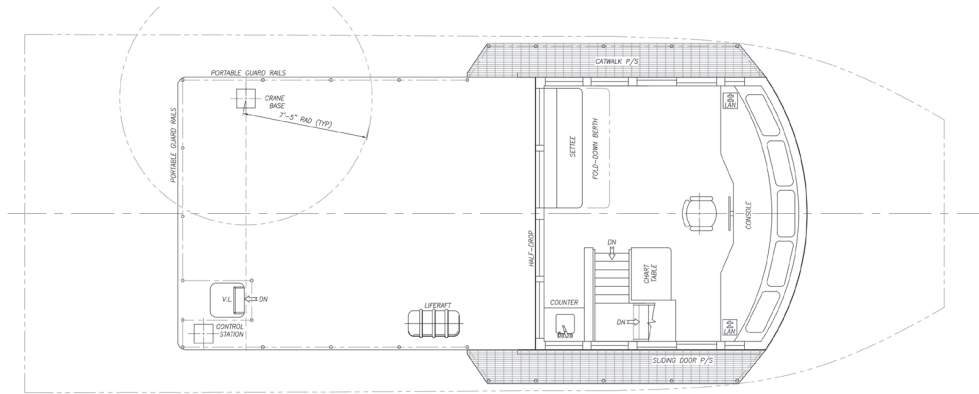

RF-06024

## 60' Aluminum Catamaran

Crowley Maritime's Vessel Design and Engineering team (Jensen Maritime Consultants) provided design guidance and customer representation for the Kvichak-built 60'x24' aluminum catamaran research vessel *Sentinel*. *Sentinel's* primary application is monitoring water quality, phytoplankton, zooplankton and benthic macro-invertebrates. This vessel replaced the 56' *R/V San Carlos* that was in operation since 1976. The new vessel operates in the San Francisco Bay Estuary, San Pablo Bay Estuary and the Pacific Ocean within five miles of shore and the adjoining inland waterways.



PILOT HOUSE PLAN  
SCALE: 3/8"=1'-0"

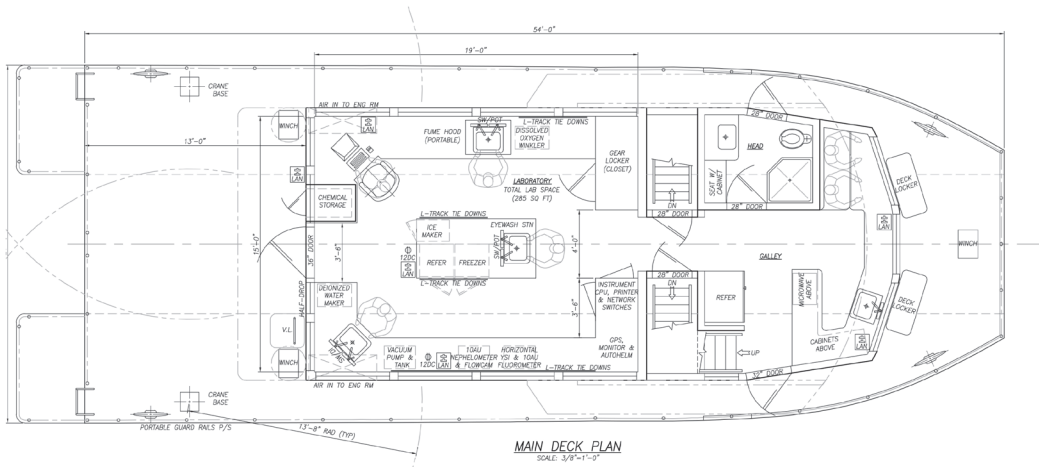

MAIN DECK PLAN  
SCALE: 3/8"=1'-0"

# Vessel Specifications

## Overall Dimensions

Length Overall	up to 60'	Crew Complement	1 + 4 scientists + 20 passengers
Length Overall, Molded Hull	up to 56'	Fuel Oil Capacity	TBD gallons (900 gal minimum)
Breadth, Molded	up to 24'	Fresh Water Capacity	250 gallons (minimum)
Depth, Molded	TBD	Black Water Capacity	50 gallons (minimum)
Draft, Maximum	3' - 6" (maximum including all appendages, less is preferred)	Hydraulic Oil Capacity	TBD gallons
Speed in Full Load Condition	20+ knots (minimum) at 85% DSR	Lube Oil Capacity	TBD gallons
Trolling Speed	2 knots (target)	Waste Oil Capacity	TBD gallons
Propulsion	2 x Tier III Marine Diesel Engines	Displacement, Full Load	TBD LT
Engine Horsepower (each)	TBD	Trim and Heel	less than 1/4 degree

206.332.8090

[crowley.com/vesseldesign](http://crowley.com/vesseldesign)  
Seattle, WA • Jacksonville, FL

**CROWLEY**<sup>®</sup>  
People Who Know<sup>®</sup>